

CARTRIDGE VALVES

SHUTTLE VALVES



SAE8

FEATURES

- ✓ Excellent Response to Pressure Changes
- ✓ Hardened Working Parts for Long Life
- ✓ Low Leakage
- ✓ Industry Common Cavity
- ✓ Compact Size

Specifications

1. Operating Pressure: 3000 PSI, (207 Bar)
2. Temperature: -30°F - +250°F (-35°C - +120°C)
3. Fluids: Mineral based fluids. For other fluid compatibility consult factory.
4. Recommended Filtration: Critical Application: ISO 16/12
Non-Critical Application: ISO 19/15
5. Body Material: Anodized 6061T6 aluminum alloy rated at 3000 PSI (207 Bar)

Symbol

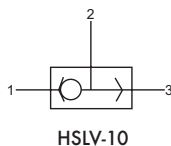

Flow Characteristics

HSLV-10

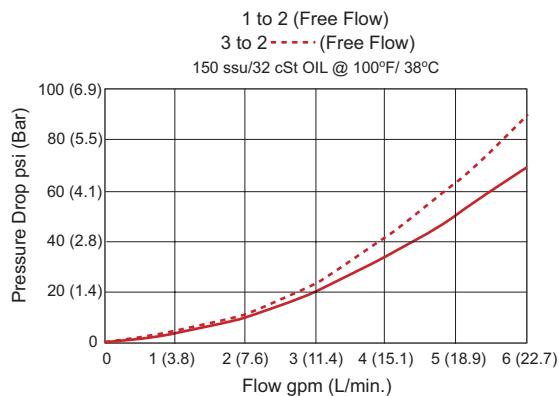

Dimensional Data

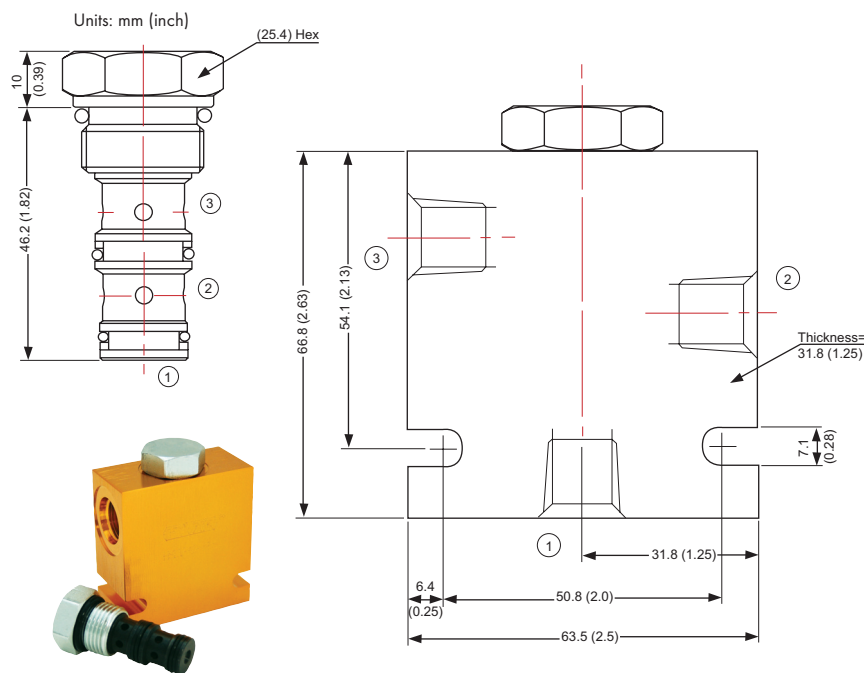

ORDERING INFORMATION



CARTRIDGE SHUTTLE VALVE PART NUMBERING SYSTEM:

HSLV-10-8FS

Code	Description	Cavity	Code	Body Porting
HSLV	Ball Type, Shuttle Valve	10	omit	Cartridge Only
			8FS	SAE8